

# Inspired Philanthropy



## Inside

- 2 Leaders' Message
- 3 Incident Command
- 4 *Building Momentum*  
Campaign Update
- 6 An Unexpected Broken Heart
- 8 Heartfelt Help from Strangers
- 10 Lakeshore Campus Update
- 12 Safe Kids West Michigan
- 20 Corporate & Community Support
- 22 Planning a Future Gift

for friends and donors of  
Mercy Health  
Office of Philanthropy

WINTER 2022

BeRemarkable.



**Tim Lopez**  
shares his remarkable  
journey to a healthy  
heart after emergency  
open-heart surgery

## Greetings,



**Gary Allore,**  
President  
Mercy Health Muskegon

February, heart month, is a good time to share how important it is to take care of your heart. Whether it is learning about your risk factors for heart disease, considering healthier eating options or putting your best foot forward by walking more, your heart health is important. By each of us doing our part, we can create a healthier community.

The community support our health system has received throughout the pandemic has been extraordinary. Thank you for recognizing the demands placed on our medical staff and colleagues. The encouragement, through donated meals, cards, treats and prayers gives us strength and reminds us that our community is behind us.

The resiliency of our medical staff, nurses, colleagues and volunteers continues to amaze. In every area, they have stepped up, in countless ways, facing daily challenges brought by the pandemic with grace, compassion and determination. No words can express how much we appreciate our staff for all they do for our patients.

Looking ahead, we are excited to share the success of the *Building Momentum* campaign for the new medical center as well as some upcoming projects and programs in this issue that rely on philanthropic support. These include the Mercy Heart Center, Safe Kids, Safe Sleep for newborns, and more.

At Mercy Health Muskegon, we have much to be thankful for, especially you — our donors and friends. We are grateful for every philanthropic gift. Each one strengthens our mission to provide exceptional care.

Thank you for your support and be sure to keep your heart healthy in 2022.

With sincere appreciation,



**Claudine Weber,**  
Chief Philanthropy  
Officer  
Mercy Health Muskegon



**Our mission inspires us to serve together as a compassionate,  
transforming healing presence in our communities.**

# Always Ready Thanks to Incident Command

Long before the pandemic, Mercy Health has had an incident command structure in place to help our health system navigate any crisis.

Led by David (Dave) Ogren, EMT-P, CHEC, Emergency Management Coordinator, the Incident Command team has helped Mercy Health identify and address potential issues, like supply or medication shortages and staffing or patient concerns.

Whenever there is an emergency, Dave is on site, no matter the time of day. Dave is a calming presence for staff, but he is undeterred when in crisis mode.

*“Our teams aim to break barriers,” said Dave. “If a problem arises, our goal is to fix it now. When our leaders and decision makers meet to address any situation, our mindset is — Just do it. Let’s get it done!”*

Through the most recent pandemic surge, when many staff had COVID-19 and were not able to work, Mercy Health colleagues stepped up to help in other departments, whenever and wherever needed.



David Ogren, EMT-P, CHEC,  
Emergency Management  
Coordinator

“As an organization, we’ve had more than the pandemic these last few years,” said Dave.

“There have been deaths, major system-wide changes and campus consolidation. Regardless, our



David Ogren (left), Emergency Management Coordinator, and Leslie Gabriel (right), Emergency Department Supervisor, work together to address a need in the Emergency Department. These two, along with many others, have been key to our successful COVID-19 response.

colleagues continued to provide top-level care. Everyone had to do their job to the maximum.”

As incident commander, Dave is always on call and helps teams address any issues that surface.

When not in crisis mode, Dave makes sure his colleagues are prepared in case of any disaster, like a mass casualty, flood or fire, an active shooter, or the need to assist another health system in West Michigan (Region 6).

Our community’s support is evident to Dave through the many deliveries of meals, treats and cards for staff. Additionally, contributions to the COVID-19 Response Fund over the past two years have made a difference when it was needed most.

*“How our community has supported us is phenomenal,” said Dave. “How our colleagues support one another is beyond extraordinary.”*

“Even after all that our teams have been through, we are still prepared for any situation.”

Learning that you or a loved one has heart disease is life changing. However, educating yourself about this disease is the first step toward feeling better and making choices that can help you live a longer and healthier life.

For more information, visit: <https://bit.ly/2V3M8ZY>



# Building Momentum Capital Campaign Update

The *Building Momentum* campaign is the most significant philanthropic effort in our history. Through the efforts of our Mercy Health Philanthropy Council, and the remarkable support from our donors, over \$14 million was raised in support of our new Mercy Health Muskegon medical center and the following two projects that are currently under construction.

## The Roger W. Spoelman Conference & Learning Center

*Now under construction and slated for completion this spring.*

The Roger W. Spoelman Conference & Learning Center is located in the garden level of the Mercy Campus. It is an 8,000 sq. ft. facility designed for department meetings, patient education, professional development and more. Named for past president and CEO, Roger W. Spoelman, this space will honor his steadfast commitment to innovation and continuous learning.

Featuring a large 4,100 sq. ft. main conference room, three smaller conference rooms, modern aesthetics and the latest in technologies and A/V capabilities; the space will be customizable to host most any size event or multiple events at one time.

*“This space is crucial to the training of our medical students and residents. It’s going to be a great asset that will help our medical staff and clinical teams keep up to date and well trained.”*

~Jerry Evans, MD, Chief of Staff



Architectural rendering of the entrance into the Roger W. Spoelman Conference & Learning Center



Architectural view into the Roger W. Spoelman Conference & Learning Center



President Gary Allore, left, and Lon Morrisson, right, Senior Director of Facilities Services, in the future conference center

## The Healing Garden

*Construction is slated for completion in late spring.*

This four-season, accessible outdoor space will soon be open for colleagues, patients and guests to walk, reflect and find solace in a natural setting without leaving the hospital grounds. Located along the hospital's main entrance, it will feature a common area with a lawn and walking paths. It will be a sign to patients, family members, staff and visitors that this is a place of healing for body, mind and spirit.

Thanks to the capstone gift made by Brad Playford, the Healing Garden will be named in honor of his wife, Kathleen Playford and family friend, Jan Spoelman.

**The restorative power of nature is well recognized, yet it is often not easily accessible in the hospital setting. There are significant findings strongly suggesting well-designed hospital gardens help reduce stress, improve clinical outcomes and heighten patient and family satisfaction.**

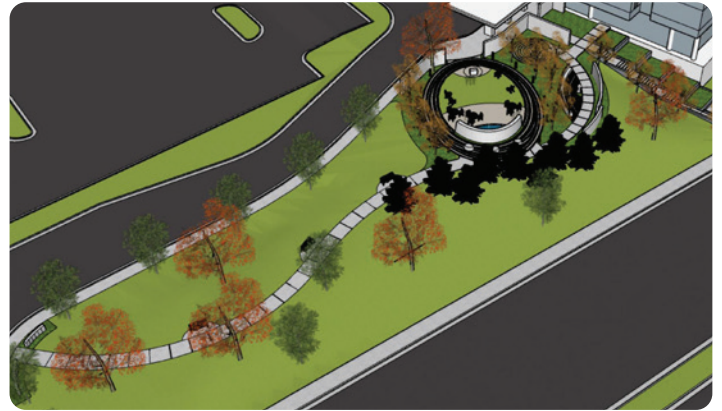

Architectural rendering of the Healing Garden



Current construction progress of the Healing Garden



Architectural rendering of the Healing Garden entrance



Current construction view of the entrance into the Healing Garden

**These two projects are being funded solely through philanthropic donations.**

We are in the final stretch of wrapping up our *Building Momentum* capital campaign efforts. Gifts to the Roger W. Spoelman Conference & Learning Center and the Healing Garden are welcome and help provide for the long-term sustainability and care of the spaces. All gifts are recognized, regardless of size, in thoughtful ways. To learn more, contact Claudine Weber, Chief Philanthropy Officer, at 231-672-3896 or [weberch@mercyhealth.com](mailto:weberch@mercyhealth.com).



Tim Lopez

## An Unexpected Broken Heart

**"If you had gone to sleep tonight, you wouldn't have woken up."** These are the sobering words Tim Lopez's medical team said to him before his emergency open-heart surgery in September 2021. For this 42-year-old, lifelong Muskegon resident, his survival and recovery after an extremely rare condition — an aortic dissection — is remarkable.

Even before his surgery, Tim lived a healthy and active lifestyle by working out regularly and running. He is married and works as the development and events manager for Kids' Food Basket.

On a warm fall day, while at Phyt Physique gym doing his usual push/pull exercises with a partner, Tim felt a pop. Then, he was struck with back pain and became light headed. He thought he had pulled a muscle in his back. After a brief rest, he jumped back in and completed his workout.

Still not feeling well, Tim went home and showered. He took it easy that evening and slept.

When he awoke in the morning, his back pain had dulled. Throughout the day, he developed a sharp abdominal pain that intensified enough that his wife rushed home to take him to the Mercy Health Fazakerley Family Emergency & Trauma Center.

On that Saturday evening, thirty hours after his injury, he arrived at the hospital hoping for pain relief, still convinced it was only a pulled muscle. Staff recognized his critical condition immediately and wasted no time.

Tim's blood pressure was sky high. Stat X-rays and an MRI were done. His medical team gathered swiftly. His aortic valve had torn away from his heart. He needed emergency surgery.

Tim's condition was explained to him in simple terms. 'There is a sack or membrane around the aorta. Your aorta has detached and the sack is filled with blood. Your heart is getting some blood because the membrane is containing it, but it could burst at any second.'

It happened so quickly, Tim said, "I barely had time to call my closest family and friends."

Richard Downey, MD, from Mercy Health Physician Partners (MHPP) Cardiothoracic Surgery, led the surgical team with his colleague Shelly Bansal, MD, assisting. Tim now has a new mechanical aortic valve. He recovered in the Intensive Care Unit (ICU) for eight days and was released home on the ninth day. His recovery has been demanding.

One of Tim's earliest memories was while he was still in the ICU. Rick Hyatt, cardiac rehabilitation coordinator, was first

to start Tim on the road to recovery. Rick told him, 'Today, you are going to walk.' Tim thought Rick was crazy. Rick said, 'You'll thank me later.' Rick was right. Tim is incredibly thankful for the connection and a real sense of sincerity he felt with Rick as he pushed him during those first days of recovery.

Three weeks after surgery, Tim started cardiac rehabilitation at the Mercy Heart Center. On the first day, walking on a treadmill for only a couple minutes at a very low speed totally exhausted him.

He couldn't imagine how he'd go from barely being able to walk on a treadmill for a couple minutes to running again.

His ultimate goal was to get back to normal. For Tim, normal was running again and being able to attend Boot Camp classes at the gym.

Stacey McManus, his lead cardiac rehabilitation coordinator, also a runner, told him he would be running again.

When Tim got discouraged, he focused on being grateful to be alive. He noticed the words *Be Remarkable* on the coordinators' name badges. It motivated him. At every appointment, he pushed himself to do more, to be remarkable.

Undetected high blood pressure was the cause of his tear. His strong heart likely kept him alive for the hours leading up to his surgery, along with his faith and many people who were already rallying to pray for him. In addition to his routine primary care visits, he now sees his cardiologist, Eric Shafer, DO, MHPP West Shore Cardiology, regularly and he takes blood pressure and heart medication.

***"Everyone at Mercy Health has truly gone above and beyond," said Tim. "I am grateful to have had an amazing, world-class heart team in here in my hometown. They saved my life."***



Tim Lopez with cardiac rehabilitation coordinators Stacey McManus and Angie Barclay

"Throughout my recovery, I was made aware that most people in this situation don't live to talk about it. The expertise of the teams, the technology and the quick response is something I am beyond grateful to have had access to."

Tim is thankful for his cardiac rehabilitation coordinators — Rick, Stacey, Angie Barclay and Julie Johnson. He recently returned to the Mercy Heart Center to show his gratitude.

Today, Tim has begun training for a half marathon, and he is a regular at Boot Camp classes again. And, to cheer him on, his Heart Center team came to surprise him and work out with him on his first day back at class!

Tim is getting back to normal and overjoyed to be living "Life 2.0."

**The Mercy Heart Center** is a comprehensive wellness and rehabilitation center. Heart Center staff help hundreds of cardiac patients each year to gain their optimal health. The Office of Philanthropy supports the Heart Center through cardiac rehabilitation scholarships for those who are underinsured or uninsured. The need for our community's support for healthy hearts and the Mercy Heart Center remains a priority.

We invite you to consider becoming a supporter. To learn more, please call 231-672-4890 or email [mhphilanthropy@mercyhealth.com](mailto:mhphilanthropy@mercyhealth.com).

**Know the signs and symptoms of a heart attack.**

Learn more at <https://bit.ly/36SS3Wu>



# Heartfelt Help from Strangers



Armen Kassouni

Armen Kassouni, 61, isn't in the habit of using Facebook messenger to communicate with people he has never formally met, but in this case, he has made an exception.

His message to the two men he contacted was this: "I'm back on my bike, thanks to you guys."

That's because on October 30, 2021, after riding his mountain bike on the trails at Mosquito Creek near Muskegon, Kassouni suffered a heart attack. These two strangers were among the first to save his life.

"My friends and I had just finished a 25-mile trail ride and were in the parking lot. Apparently, I fell on the ground and threw up, but I have no memory of it. Thankfully, [my friends] rolled me over and cleared my passageway."

Two other men happened to also be in the parking lot: Mark Tourcotte, a Mercy Health Muskegon registered EEG (electro encephalographic) technologist, and Steven Schrader, an EMT for White Lake Ambulance

Authority and Lieutenant with Blue Lake Township Fire Department. Ironically, neither cyclist was planning to be there at that time.

## Right Place, Right Time

Tourcotte had the day off so he could attend his son's soccer game, but his son was ill. Instead of going to the game, Tourcotte decided to ride his mountain bike on the nearby trails. Typically, this avid cyclist loves to hit the jumps on the trails ... repeatedly.

"Something that day told me not to do it. Instead, I should ride as fast as I can and work on my time, and I never do that. For some reason I listened to the voice in my head," said Tourcotte. When his ride ended at the parking lot, he noticed that several people were on the ground.

Tourcotte went to see what was happening and felt for Kassouni's pulse but "there was nothing there. I started CPR immediately." Again, circumstances aligned for this medical professional to be prepared for that moment. "At work we renew our CPR cards every two years. In addition to this, we are now required to do interactive modules every three months. This involves different CPR scenarios, as well as additional manikin training to further maintain and perfect skills. I literally had just completed my most recent module, so everything was fresh in my mind. I didn't have to think. I just knew what to do."

"After a few minutes, another gentleman approached to offer help. He introduced himself as an off-duty EMT, and we traded off doing chest compressions until the paramedics arrived. They shocked Kassouni into a sinus rhythm immediately."

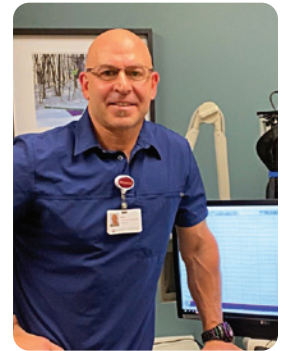

Mark Tourcotte



Steven Schrader



Schrader was fitting in a ride that day between fixing his brakes and reporting for a shift later. He arrived for his mountain bike ride later than he had hoped. While unloading his bike, he noticed a man in the parking lot walking back and forth with his cell phone looking concerned. Then when he began his ride, he saw someone on the ground and rode over to help.

“Mark and I took turns with CPR and keeping Armen’s airway open. Because of my background as a firefighter and EMT, I have seen this scenario play out many times. Time is critical and as we provided continuous chest compressions, we were also able to get the patient ready for the AED (automated external defibrillator) by getting his shirt off. We maintained compressions as the paramedics applied the AED, and even as the AED charged,” Schrader recalled. That saved valuable time.

### **Kassouni’s Recollection**

Although unconscious at the time, Kassouni continued the story based on what others told him.

“The two strangers knew immediately what was up. While my friends called 9-1-1, these two men began CPR on me. When the ambulance arrived, the team used defibrillation on me. I understand they did it again during the ride to the emergency room at Mercy Health in Muskegon.”

Kassouni’s recollections after that are disjointed. He remembers first “meeting” Cardiologist Scott Harris, DO, in the Intensive Care Unit (ICU) — after he, too, saved Kassouni’s life.

“I had a ‘widow maker’ heart attack and survived it. Dr. Harris placed a stent in one of my arteries, which was 95 percent blocked.”

As a person who regularly exercises, gets annual checkups, and was not on any medications for heart issues, Kassouni did not expect to have a heart attack. His older brother had serious heart issues, so to be cautious, Kassouni had a CT scan checking for plaque buildup in his arteries earlier that year. The scan showed no buildup.

Nonetheless, Dr. Harris concluded that soft plaque, which was undetected by the CT scan, had caused his patient’s heart attack.

Thanks to the quick actions of everyone involved, Kassouni says, “Dr. Harris said my heart bounced back amazingly well to the point that it was difficult to tell I even had a heart attack.”

### **Quality Care**

Kassouni does remember his time in the ICU. “I love those people. Everyone at Mercy Health was very accommodating. I had eight broken ribs from the CPR, and I was coughing a lot and making a lot of noise. Everyone was extremely nice to me. Even with COVID going on, the staff who came in and out during the different shifts were polite and helpful. I can’t say anything but good things about the entire staff.”

Following his procedure, Kassouni was referred to cardiac rehabilitation at Mercy Health Saint Mary’s in Grand Rapids, which is closer to his work and home. “I go there three times a week, and they work you out for an hour. The care I got at Mercy Health was second-to-none.”

### **A Message for All Readers**

Kassouni, Tourcotte, and Schrader cannot stress enough the importance of everyday people learning CPR.

***“Don’t hesitate. Get trained immediately. It’s not hard. Your actions could save someone’s life,” said Tourcotte. “And keep your skills up.”***

Schrader agrees. “There won’t always be another person in a crisis to do CPR. Take advantage of any community training you can get.”

As a member of the West Michigan Mountain Bike Alliance, Kassouni and others are now planning a CPR class for all the members. That’s one way he is trying to increase awareness of CPR training.

Back on his bike since December, Kassouni also has this message for others: “Dr. Harris indicated that one of the reasons I survived is that I exercise. I would send everyone a message that you need to exercise.”

Sound advice from a true survivor!



# An Interview with John Foss

Vice President, Lakeshore Campus, and Hospital Medicine  
Physician Assistant (PA-C)

John Foss leads Mercy Health Lakeshore Campus in Shelby, Michigan, a 24-bed, critical access hospital and an important medical hub for the community. The leadership team includes Melissa Schneider, Director of Nursing Services, and Cory Johnson, Laboratory Manager. Working together, this trio's vision is resulting in innovative care and service expansion.

### What impact has the pandemic had on the Lakeshore Campus?

We're known for being a well-kept secret with a family atmosphere. Due to the pandemic, many people have recently discovered us.

When the pandemic first began, COVID-19 inpatients were cared for in other places. When patients came here for their outpatient tests, they realized they could get in and out quickly.

This resulted in our numbers going through the roof and they haven't slowed since.

### What are your goals for Lakeshore Campus?

The goal has been to provide high quality care locally so that most patients could get their care here at home. Given the constraints of larger hospitals during the pandemic, we worked to keep more patients here.

There has been an increase in specialty physicians (emergency medicine, hospitalists and general surgeons) to the campus. The typical daily inpatient census is now five or six patients, up from the average of one or two from three years ago.

Our emergency medicine and hospitalist physicians are adept at identifying the patients who can be well cared for here and those who need to be transferred. When transferring patients to Muskegon, the process is seamless since our physicians are part of the Mercy Health network.



Melissa Schneider  
Director of Nursing Services



Cory Johnson  
Laboratory Manager

### What was the Lakeshore Campus involvement with the pandemic response?

Lakeshore Campus has been an active site for COVID-19 vaccinations and monoclonal antibody administration.

Historically, transferring patients from the Lakeshore Campus to other facilities was the norm.

During the surges, when inpatient beds in larger hospitals were in short supply, our leaders recognized we had a team ready and able to accept COVID-19 patients.

We have accepted and cared for many inpatients from other facilities who had never heard of us or been to Shelby.

Our leaders and I made it a point to check in with every patient every day to make sure their stay was going well, because they didn't choose to be here. Everyone has had a positive experience, and a lot of them are coming back for return care.

### **Did you take other patients during the pandemic?**

Yes. To keep bariatric patients in Muskegon from having their surgeries postponed, we brought the surgeon, equipment and staff to Shelby.

This is a specialized surgery we did not do here. However, recognizing all that patients go through to get ready for surgery, we made sure the patients got the care they needed when they needed it.

### **How is patient care changing at Lakeshore Campus?**

We have made several investments. An example is how we are speeding up testing for stroke. We can now conduct perfusion CT scans.

If your loved one were to come in with stroke symptoms, this test helps us know if an emergency transfer is needed and to where — Muskegon or Grand Rapids. Previously, this test was done on arrival in Muskegon. Some patients were transferred a second time to Grand Rapids, wasting precious time.

By doing the perfusion CT scan here, our patients are immediately sent to the correct site of care.

We're also looking at getting a telehealth robot so that the Mercy Health Hauenstein Neurosciences team can evaluate our stroke patients, in real time, and determine where their optimal care site will be.

### **Does your Emergency Department accept chest pain patients?**

Yes. Our Emergency Department staff are well trained. They immediately stabilize the patients and transfer them to the cardiology teams in Muskegon.

Having the same emergency medicine group, and with the help of ProMed

and Life EMS, we make emergency transfers seamless.

A cardiologist recently thanked us for the great care his patient received and for how rapidly we got this person to Muskegon for a cardiac catheterization. This patient coded here and was revived before transfer. The patient is now doing fine.

When we are needed, our cardiac response is exceptional.

### **What plans are in the future for Lakeshore Campus?**

Having a two-bed Intensive Care Unit (ICU) would be ideal. This would allow us to keep patients who are septic or intubated overnight. We already have staff who are trained to care for these patients.

We are also looking at expanding surgical services by adding more orthopedic cases and specialty procedures for urology.

### **What makes you proud of the Lakeshore Campus?**

When patients stay here, they feel like they are a part of our family. Throughout the pandemic, our team has been extraordinarily resilient. They help each other and they are ready for anything.

I am excited about what lies ahead and I am proud of the exceptional care our team provides for our patients every day.

*To learn more about supporting Mercy Health Lakeshore Campus, contact the Office of Philanthropy at 231-672-4890 or [mhphilanthropy@mercyhealth.com](mailto:mhphilanthropy@mercyhealth.com).*

### **Lakeshore Campus is part of a network of four primary care rural health clinics:**

**Mercy Health Physician Partners Sable Pointe** (*Ludington*)

**Mercy Health Physician Partners Hart Family Medicine**

**Mercy Health Physician Partners Shelby Family Medicine**

**Mercy Health Physician Partners Lakeshore Medical Whitehall**

### **Recent Investments**

- Nurse call system
- Telemetry
- Digital radiology
- CT Scanner (with perfusion)

### **Future Needs and Opportunities**

- New inpatient beds
- Telehealth, access to specialists
- A two-bed ICU
- Advanced surgical services

## **Gratitude for New Equipment**

In 1993, the Lakeshore Community Hospital Endowment Fund was established at the Community Foundation for Oceana County to support future needs of the hospital. Each year, the investment proceeds fund equipment purchases like a bladder scanner and a Medfusion® Syringe Pump (a device used to deliver medication).

Most recently, an anonymous family, through their donor advised fund, made a grant for the purchase of 13 Stryker stretchers needed at the Lakeshore Campus. The new stretchers include built-in scales, are safer and more comfortable.

# Keeping Kids Safe in West Michigan

Safe Kids West Michigan (SKWM), a Mercy Health program, is dedicated to reducing preventable childhood injuries and deaths. In 2020, Mercy Health Emergency Departments in Muskegon and Shelby, Michigan, treated 391 children who were injured in car (213), bike (124) and burn or scald (54) accidents.

SKWM, led by Holly Alway, Injury Prevention Coordinator, works in partnership with local fire and police departments, schools, community organizations, parents and caregivers to serve families in Lake, Mason, Muskegon, Oceana and Northern Ottawa counties.

In 2020, when 391 kids were injured, SKWM gave out (at no cost) 169 car seats, 19 booster seats, 240 bike helmets and 50 smoke alarms to those in need, likely saving countless additional injuries. The most important benefit of proper safety devices and the education SKWM provides is obvious — keeping kids alive.

*“Plainly speaking, it is better for all if we can prevent, rather than treat injuries,” said Holly. “Safe Kids wouldn’t be possible without philanthropic support from our community.”*

There is a second benefit to keeping kids safe — the cost savings. Every dollar in program costs is compared to the estimated value of the number of prevented injuries and lives saved. For the 2020 distribution (car seats, boosters, helmets and smoke alarms) the benefit to our community in terms of the cost of prevented injuries was a remarkable \$1,488,100!

While Mercy Health Muskegon covers the administrative costs of SKWM, grants and donations are needed to directly fund SKWM and the safety devices distributed throughout our communities.

“Injury prevention is at the core of our Mercy Health mission to be a healing presence in our community,” said Holly.

*“It is my role to help people understand the risks in their environment and equip them with knowledge and the safety devices to reduce that risk.”*

The injury prevention program at Mercy Health provides direct services to thousands of people each year. Together, with our community partners and support from our donors, we are making a difference.



Holly Alway, right, fitting a young girl for a right-sized bike helmet



Right, Dep. Chris Herremans, Muskegon County Sheriff's Office, helping a local dad with his infant's car seat installation



### About Holly Alway

Safe Kids West Michigan is led by Holly Alway, Injury Prevention Coordinator for Mercy Health Muskegon. Holly holds bachelor's degrees in Behavioral Science and Criminal Justice, and a master's degree in Transportation Safety Administration. Last year, Holly celebrated her 20<sup>th</sup> anniversary with Mercy Health and Safe Kids West Michigan.

### Women for Health Funds Safe Kids West Michigan

Recently, Safe Kids West Michigan was chosen as the 2021 recipient of a \$40,000 gift from Women for Health, a 37-member Mercy Health women's giving club.

**In addition to 240 infant car seats, this gift will help establish a car seat evaluation clinic for children with special needs in West Michigan.**

Currently, families must drive to Ann Arbor for this service, which includes a required car seat fitting for their child. Without it, insurance coverage is not possible, and families may be forced to travel with their children in unsafe situations or keep them from leaving their homes.

### The Tommy Davis Memorial Fund

The Tommy Davis Memorial Fund is in its second year of supporting the Mercy Health Safe Kids West Michigan Home Safety Program. **In 2021, 184 home safety devices — smoke detectors, medication lock boxes, baby gates, door alarms, gun locks and more — were distributed thanks to funding from the Tommy Davis Memorial Fund!**

Tommy Davis was a Senior Financial Analyst for the Health Project, the community benefit ministry of Mercy Health, at the time of his death in 2018 at age 30. Tommy was a bright light to all who knew him, and now, his mother, Sherri Davis, is sharing that light with the community through the Tommy Davis Memorial Fund.

*If you would like to learn more about how to support Safe Kids West Michigan or how to become a member of Women for Health, please contact Emma Peterson at 231-672-4814 or [emma.torresen@mercyhealth.com](mailto:emma.torresen@mercyhealth.com).*

## Safe Sleep for Babies Fund

1,800 babies are born annually at the Birth Center. While newborns are in our care, safe sleep is modeled and taught to families. A safety recommendation we make to parents is to remove loose blankets from baby's sleep area and replace them with a SleepSack®, a special wearable blanket with armholes that prevents fabric from covering baby's face.

Since September 2021, the Office of Philanthropy has funded one SleepSack® for each baby. Recognizing the need will continue for years to come, we asked our donors at year end to help us continue to fund them through 2022. Thanks to a generous response, we met our goal and the Safe Sleep for Babies Fund is now an ongoing philanthropic program.

SleepSacks® will also be available for purchase in our Gift Shoppes, at cost, to encourage families to have more than one for their newborn.



OFFICE OF PHILANTHROPY  
MERCY HEALTH

BeRemarkable.

# With Gratitude to our Community

Mercy Health Muskegon is honored to present the names of our supporters. Their expressions of generosity have helped to build the facilities, programs and technologies that allow us to provide advanced medicine and compassionate care to our lakeshore communities.

## President's Circle

Recognizing lifetime cumulative gifts and pledges of \$25,000+



Charles & Julia Hackley  
Mark & Christine Fazakerley  
Community Foundation for  
Muskegon County  
Lobbyside Café Guild  
Mercy Health Volunteers  
Osteopathic Foundation of West  
Michigan  
Sandy Corley Memorial Run  
Mrs. Rosalie R. Youngberg



Howmet Aerospace Foundation  
Thomas & Alice Benton  
Cars for Cancer  
Robert L. & Donna J. Chandonnet  
Deborah DeVoursney  
Hines Corporation  
Charles E. & Patricia B. Johnson, II  
Paul C. Johnson Foundation  
Lake Michigan Emergency  
Specialists, PLLC  
Dr. Paul Medema  
Michael & Kay Olthoff  
Brad & Kathleen Playford  
Shape Corporation  
Ms. Fanny Steketee  
J. Daniel & Mavis Thill  
Doris C. Valk  
Helen E. Valk  
John & Kathleen Workman Family



ADAC Automotive, Inc.  
Mrs. Clita R. Anderson  
David C. & Sandra R. Bliss  
John & Shelley Brocci  
Honoring Drs. M.E. & J. Max Busard  
Cannon-Muskegon Corporation  
The Christman Company  
Clifford Buck Construction  
Comerica Bank  
Community Foundation for  
Oceana County  
CWC Textron  
Lowell & Nell Dana  
Dr. Greg & Jane Downer  
Eagle Alloy, Inc.  
Fraternal Order of Eagles, Grand  
Aerie  
Hackley Visiting Nurse Services

Mr. Hans F. Hansen  
Dave & Julie Hazekamp  
Beatrice Hedenskoog  
Huntington National Bank  
J. Stevens Construction  
Steve & Deb Jackson  
Knoll Group  
Dan & Sheryl Kuznar  
Mercy Health Medical Staff  
Muskegon Surgical Associates, PC  
Steve & Deb Olsen  
Dr. Richard & Nancy Peters  
Scott & Catherine Pranger  
Quality Tool & Stamping  
Radiology Muskegon, PC  
Joseph T. Riley  
Sappi Fine Paper North America  
Sealed Power Corporation  
Alice and Charles Smith  
Roger & Jan Spoelman  
Dr. F. Remington & Ginny Sprague  
SPX Corporation  
Verizon  
Private Donor



Action Industrial Supply  
Allied Mechanical Services, Inc.  
Gary & Sue Allore  
Baker College of Muskegon  
Virginia Marshall Beardslay  
Harold E. Bowman, M.D.  
Mary & Robert Boyd  
George Cannon, Jr.  
FOE Michigan State Auxiliary  
Emergency Health Partners  
Mary Ericksen  
Fifth Third Bank  
Cora Fay Fink  
Dr. Brian & Jennifer Gluck  
Mike & Bonnie Gluhanich  
Greatest Needs Fund of the  
Grand Haven Area Community  
Foundation  
Hackley/Mercy Free Bed Guild  
Dr. Yousif & Myrna Hamati  
Harbor Steel & Supply  
Corporation  
The Hilt Foundation  
Howmet Community Foundation  
Mr. & Mrs. Robert Jewell  
Kent County EMS  
Ann G. Knooihuizen  
Dr. & Mrs. Marlin P. Krenz  
Dr. & Mrs. Steven Lessens  
Leonell Loder

Greg & Mary Loomis  
Dr. Lawrence Mallon  
Mr. Steven Morykwas  
Helen Motter Estate  
The Muskegon Chronicle  
National City Bank  
Nowak Machined Products  
Patrick J. O'Leary & Karen M.  
Yamasaki  
Dan & Kendra Olsen  
Mr. & Mrs. Gerhard Olsen  
Greg & Shelley Olson Family  
Ted & Joan Operhall  
Orthopaedic Associates of  
Muskegon, PLC  
Bryan Pereira, MD  
Dr. & Mrs. Robert Porter  
Denis & Barbara Potuznik  
Ted & Louise Price Family  
Sand Products/Mart Dock  
Mr. & Mrs. Stanley Sutherland  
Mr. Peter Turner  
David D. & C. Corcoran Tuttle  
David & Shawn Vallier Family  
Webb Chemical Service  
Corporation  
West Michigan Emergency  
Services  
Private Donor  
Private Donor



AAA Michigan  
Jeff & Pam Alexander  
Timothy D. & Cheryl L. Arter  
Harry & Lori Arthur  
Jeanne & George Bartlett  
Beacon Recycling  
Susan & Frank Bednarek  
Betten Baker Chevrolet, Cadillac,  
GMC  
Dr. Theodore & Sherry Boeve  
Dr. & Mrs. Frederick Brown  
Buist Electric  
Dr. & Mrs. J. Max Busard  
Betty J. Cawein  
Curtis & Lucille Chambers  
Denny Cherette  
County of Muskegon  
Bob and Betsy Cutler  
Mr. Jan L. Deur  
Thomas DeVoursney  
Pat & Julie Donahue  
ESCO Company  
Dr. Jerry & Beth Evans  
Dr. Robert & Susan Fles

Fruitport Eagles Womens  
Auxiliary #3666  
Geerpres, Inc.  
Mr. & Mrs. Richard F. George  
The Gerber Foundation  
John & Marty Gerencer  
Mary Anne Gorman  
Mrs. JoAnn Henke  
Dr. Thomas & Heidi Hill  
Charles E. Johnson III & Dr. Nina  
Johnson  
Herman Miller  
Herman Miller Cares  
HGA Architects and Engineers  
John & Linda Hilt  
Frederick & Susan Hohman  
Bob & Paulette Israels  
Jasam Foundation  
Revs. James & Jan Johnson  
J. Steve Mark & Camille Jourden-  
Mark  
Mr. & Mrs. L. Herb Kersman  
The Family of Donald Kettler  
Fred & Florence Kiskey  
Mr. Orié Komer  
Dr. & Mrs. David M. Krencik  
Mary G. & Norman Kruse  
Jeffrey & Kelly Kurburski  
Lague Newman & Irish  
Lakeshore Imaging Consultants,  
PLC  
Mrs. Ione Lemmen  
Lorin Industries  
Max & Nora McKee  
Dan & Schar McKinnon  
Dr. Mark & Bonnie Meengs  
Dr. David & Dianne Milek  
Mr. & Mrs. Richard Morgenstern  
Gordon Mudler  
Carol Munroe  
Muskegon Shrine Club-Masonic  
Temple  
Donald & Kristi Nagengast  
Newkirk Electric Associates  
Non-Ferrous Cast Alloys, Inc.  
Drs. Bruce & Katrina Olson  
Ms. Helen S. Park  
Drs. John LaGorio & Elizabeth Pitt  
Progressive AE  
Gordon & Antoinette Reynolds  
Muskegon Rotary  
Safe Kids Worldwide  
Merle & Bob Scolnik  
Thomas & Geraldine Seyferth  
Fund  
James & Nancy Sheridan

Robert L. & Katherine C. Smith  
James J. & Sheila G. Steffel  
Mr. & Mrs. Jim Stevens  
Dr. and Mrs. Ronald Stuk  
John & Mary Swanson  
Mrs. Harold Thurston  
Donald & Jane Tjarksen  
Mr. John Tuttle  
Tyler Sales Company, Inc.  
Gary Verplank  
Shaw & Betty Walker  
Warner Norcross + Judd  
Richard & Claudine Weber  
Mr. Basil Westgate  
Dr. Richard A. & Priscilla Wilcox  
Drs. Paul & Kristen Woods  
Dr. Stephen & Kim Zonca

## Signet Society

Recognizing lifetime cumulative gifts and pledges of \$10,000 to \$24,999

## Signet Platinum

Anderson Global / Anderson  
Express  
John & Kay Bernard  
Dr. & Mrs. Gregory Bernath  
Blue Cross Blue Shield of  
Michigan  
Mrs. Dorothy E. Boyden  
Mrs. Nancy Bunks  
Mrs. Maureen L. Campbell  
The Carls Foundation  
Dr. Paul & Jane Chovaz  
Leon & Lisa Conklin  
Dr. Donald & Nancy Crandall  
Marcia D'Oyly  
Verlyn Eisenhauer  
DTE Energy  
Doug & Kim Fenbert  
Ralph & Jennifer Fisher  
Brian & Colleen Fitch  
Dr. Mark & Tara Foreman  
Dr. & Mrs. Carl Gebuhr  
Grant & Gretchen Goltz  
Mark & Jennifer Gross  
Barney, Anna & Sister Naomi  
Holysko, RSM  
Bob & Jan Jacobs  
Wayne & Nancy Kohley  
Orié Komer  
L3 Combat Propulsion Systems  
LifeCircles

Meijer, Inc.  
Michigan Safe Kids Coalition, Inc.  
Muskegon Lumberjacks  
Charitable Foundation  
Orthopaedic Specialists of  
Muskegon, PC  
Dr. S. Andrei & Shelley Ostric  
Pacific Floorcare  
Mary L. Price  
Joseph Rafferty  
Dr. & Mrs. J. Michael Ratchford  
Dr. & Mrs. Ralph Ryan  
Dr. & Mrs. John Skallerup  
Tim Hortons  
Gene P. Viglietta & Dr. Mary Fisher  
Viglietta  
Dr. & Mrs. Norman L. Welch  
Dr. & Mrs. Daniel West  
Dr. & Mrs. Richard T. Wilcox  
Mr. & Mrs. Richard N. Witham

### Signet Gold

George & Josephine Anacker  
AMGEN  
Denise Amidon  
Mr. & Mrs. Roger A. Andersen  
Bank One  
Frederick & Ann Bleakley  
Heather Brolick  
Gerald & Michelle Buchanan  
Community Shores Bank  
Delta Dental Plan of Michigan  
Thomas & Cindy Ellis  
Dr. & Mrs. John C. Farmer  
Mrs. Esther J. Frandsen  
Dave & Judy Gingsberg  
Dr. B. Rolf & Judy Hissom  
Anne Hoekenga  
Dr. Robert & Honorable Kathy  
Hoogstra  
Independent Bank  
Patrick Jackson  
JPMorgan Chase Bank  
Dr. J. D. Kaurich  
Keene Lumber Co.  
Heather Kettler  
Dr. Ray & Betsy Komray  
Lake Michigan Credit Union  
Brian & Gay Landstrom  
Suzanne T. & William T. Leger  
Loutit Foundation  
Shirley J. Lynch  
Dr. Christopher & Marisa  
Marquart  
Dr. Janice McDonald & John King  
Bernard & Pamela McKenzie  
MHPP West Shore Cardiology  
Mr. William Munroe  
Scott & Janeé Musselman  
Nexes Realty, Inc.  
Northern Machine Tool  
Oakridge Public Schools  
Aaron & Lisa Potts  
Priority Health

Rehmann  
Reid Entities  
Mr. & Mrs. Thomas S. Reynolds  
Dr. & Mrs. James J. Rice  
Ken & Lisa Rose  
Fredrick & Dr. MaryEllen Rosel  
Dr. Bart & Jenny Sak  
Scholten & Fant, PC  
Select Specialty Hospital  
Dr. & Mrs. Peter Shireman  
Sisters of Mercy  
Rayora Spray  
Dr. & Mrs. John C. Strainer  
VanDam Family Fund of the  
Community Foundation for  
Muskegon County  
Warner-Schuitema Moving &  
Storage  
Watson Wyatt & Company  
Mrs. Ruth L. Wheaton  
Witt Buick

### Signet Silver

Cindy Ackerman  
Paula M. Andersen  
Mr. & Mrs. Stanley Andrie  
Chris & Marian Anton  
Andrew & Jenna Arter  
Dr. & Mrs. Michael Banka  
Dr. & Mrs. Anthony Barclay  
Judy Beecham & Charlie  
Ruedisueli  
Robin Belcourt  
Peter & Mhairi Blacklock  
Dr. & Mrs. Herbert M. Blair, III  
Dr. J. D. & Tammy Bond  
Jeff & Connie Boone  
Dr. James R. Bos  
R. Bouts  
Drs. Matthew & Monica Bowen  
Drs. Mathew Brakora & Maryvict  
Cusion  
Todd & Kim Bramer  
Briekley DeLong, PC  
Shane & Jennifer Buchmiller  
Mrs. Eunice Bush  
Mr. & Mrs. Paul Buterakos  
Crosswinds Fellowship  
Tommy Davis Memorial Fund  
Tom DeBoer & Karen Kremers  
John Derbin & Barbara DeLello-  
Derbin  
Steve & Kathy Demos  
Brian & Rona Dethloff  
Rick & Jan Dethloff  
Paul & Julie Dratz  
DTE Energy Foundation  
Darryl & Linda Dunmore  
David K. & Mary C. Ellis  
Dr. & Mrs. Michael Engel  
Robert & Jackie Engel  
Ernst & Young  
Mr. & Mrs. William Eyke, Jr.  
Dr. Christine Faser

Jim & Jackie Fisher  
John T. Foss & Lisa Tyjewski  
Bruce & Bonnie Fox  
Drs. Steven & Alison Fox  
Keith & Cheryl Goodell  
Dr. Justin & Carrie Grill  
Julie Tuttle Gunderson  
Kimberly L. Hammond  
Rod & Lydia Hayhurst  
Mark & Dianne Hoofman/ProFab  
Otto & Brenda Hopma  
Mr. & Mrs. Warren Hutchins  
Lindy Ihrman  
Investment Property Associates  
Kelly & Eric Jensen  
Peter C. & Julie A. Johnson  
Karen Kayes  
Rob & Amy Kendall  
Robert & Wendy Kersman  
Gary J. & Joan K. Kessler  
Craig & Phyllis Killingbeck  
Sherri King  
Robert & Dr. Michelle Klanke  
Dr. & Mrs. I. J. Kleaveland  
Kurdziel Industries, Inc.  
Paul & Dr. Heather LaClair  
Greg & Diane LaPres  
Dr. Fred & Pam Levin  
Mr. & Mrs. Steven M. Lohman  
James & Kimberly Maguire  
Dr. Carol Markiewicz & Mr. Bill  
Gierke  
McKesson/HBOC  
Metal Arc, Inc.  
MetLife Resources  
MHPP Shoreline Neurosurgical  
Consulting  
Cory & Charisse Mitchell  
Diane & Vern Molitor  
Drs. Mark & Mary Moulton  
Dr. & Mrs. Richard Moulton  
Thomas A. & Carol Munroe  
Mr. & Mrs. Thomas E. Munroe  
Muskegon Construction Company  
Muskegon Fury  
Dr. & Mrs. Alejandro Nakahodo  
Newaygo County District Health  
Dept. No. 10  
Nichols Paper & Supply  
Joe & Denise O'Neill  
Kenneth & Merilee Otto  
Emma & Frank Peterson  
Mrs. Esther Pettyjohn  
Pressures & Pipes, Inc.  
Mrs. Helen B. Pyle  
Dr. Jeffrey & Betty Recknagel  
Dr. Jeffrey Rewitzer  
Dr. & Mrs. Charley Roesch  
Ronald McDonald House  
Charities, Inc.  
Mr. & Mrs. Harold Rosen  
Dennis & Sally Rynberg  
Dr. Joseph & Sheila Salisz  
Dr. & Mrs. Michael Schmidt  
Dr. & Mrs. Robert Schneeberger

Arnold & Doris Schuppert  
Geraldine Seyferth & Harvey  
Anderson  
Steve Smith & Kay Beebe Smith  
Dr. & Mrs. Vance Smith  
I. John & Kathleen Snider, II  
Dr. Kevin & Therese Stone  
Triangle Associates, Inc.  
VanKampen Boyer Molinari  
Foundation  
Tony & Monica Verplank  
Shaw & Betty Walker Foundation  
Josh & Amber Wallace  
Mike Weessies  
Dr. & Mrs. Daniel Weller  
West Coast Anesthesia, PC  
West Michigan Cardiovascular  
Surgeons, PC  
Timothy & Cynthia Westra  
Dr. Douglas & Jennifer Zwemer

### Heritage Society

Recognizing individuals who  
have provided for the future of  
Mercy Health and our community  
through an estate or planned gift.

Mr. & Mrs. Hans H. Agard  
Gary & Sue Allore  
David Amos, MD  
Harold Andersen  
Clita Anderson  
Richard F. Ashley & Rosemarie  
Konopa-Ashley  
Mr. & Mrs. Douglas C. Bard  
Mhairi & Peter Blacklock  
Mary & Robert Boyd  
Shelley A. Brocci  
Nancy Bunks  
Mrs. Eunice Bush  
Charlotte & Lawrence Carl  
Dr. Donald & Nancy Crandall  
Robert J. & Elizabeth M. Cutler  
Hilda W. Dobbins  
Jon & Carol Dykema  
David K. & Mary C. Ellis  
Robert S. & Jackie Engel  
Mary B. Ericksen  
Thomas & Vicki Eurich  
Mark & Christine Fazakerley  
Mrs. Roberta Fleischmann  
Charles H. & Julia Hackley  
Hans F. Hansen  
Beatrice Hedenskoog  
JoAnn Henke  
LuAnn Jackman  
Karen Kayes  
Ann Knooihuizen  
Orie Komer  
Marlin Krenz  
Mr. & Mrs. Richard C. Lague  
Ms. Helen P. Larsen  
Roger J. LeMieux  
Greg & Mary Loomis

Laura J. Martin  
Dr. Paul & Bertha Medema  
Steven Morykwas  
Helen Motter  
Mr. Gordon A. Mudler  
Marion Newlun  
Esther Pettyjohn  
Helen Poniatowski  
Joseph Riley  
Merle & Bob Scolnik  
Emil Shebesta  
Alice Smith  
Helen Smith Park  
I. John & Kathleen Snider, II  
Roger & Jan Spoelman  
James J. & Sheila G. Steffel  
Fanny Steketee  
Dorothy Stewart  
Dirk & Denise Stone  
J. Daniel & Mavis Thill  
Mr. Peter M. Turner  
Ms. Doris C. Valk  
VanDam Family Fund  
Richard & Claudine Weber  
Norma York-Bremer  
Rosalie R. Youngberg

### Cornerstone Club

Recognition of those who gave  
annual gifts of \$500 to \$9,999  
(From October 2019 to  
December 2021)

### Platinum

John (Jack) & Delores (Dolly)  
Aerts  
G.O.L.F.  
Great Lakes Coca Cola Bottling  
Group  
Pledge the Pink  
Rex & Michelle Vanderlinde

### Gold

Mishelle M. Comstock  
Epworth Church Association  
Diane & Robert Kartes  
Lions Clubs Of Michigan  
Pints & Quarts  
Safe Kids Worldwide  
Tim & Rita Thill  
Trace Analytical Laboratories, Inc.  
United Way of the Lakeshore

### Silver

Marsha Allen  
Artist Brush & Color Distributors  
Joseph & Kris Balaskovitz, Jr.  
BeBalanced Concierge  
Dr. Timothy & JoAnn Beechnau  
Benona Shores Golf Course  
Bradley & Rebecca Billingham

David L. Bishop  
Bob Evans (Apple Ave.)  
Timothy & Katie Brewer  
Barbara A. Brooks  
David Brown & Bonnie  
Adamczak-Brown  
Cancer & Hematology Centers of  
West MI  
Christ Church of Muskegon  
Nichole Coolsen  
Corporate Portfolio  
Honoring Annette Bouchard  
Crevier  
Albert & Doris Cwiakala  
Lena DeJohn  
Diekema Hamann Architects and  
Engineers  
DJ's Landscape Management  
Dr. Rolf's BBQ  
Teresa E. Dye  
James Elam  
Shannon & Lisa Enders  
Esther & Sara's Bakery LLC  
Family Financial Credit Union  
Lydia Farrell  
Fatty Lumpkin's Sandwich Shack  
Fetch Brewing  
Fremont Insurance Agency  
Alexandria Fricano  
Fricano's Muskegon Lake  
Harbor Hospice & Harbor  
Palliative Care  
Gerald & Nancy Harriman  
Benjamin Hayes  
Theresa Hegedus, DDS  
Thomas & Janice Hylland  
Brenda & Jim Jacobs  
Lilly M. Janowiak  
Tabitha R. Johnson  
Kim Kitchen  
Stephen & Kay Korc  
Ladies Who Lunch  
Cindy M. Larsen  
Barbara Lauretti  
Lefty & Romos' Bar & Grill  
Holly Lowney  
Aaron & Shanna Maike  
Ray McLeod  
Michigan Nonprofit Association  
Gary Neal & Chris McGuigan  
New Light Baptist Church  
Jonathon H. Pate  
Gary & Karen Paul  
Phase II Electric, Inc.  
Qualified Digital  
Reeths-Puffer Schools  
Richard & Christi Robinson  
Curtis & Colleen Ruppel  
Salon 297 Hair and Day Spa  
Dr. Howard & J. Christine Sanden  
Rick & Tina Shields  
Rudolph & Judith Shunta  
Smith Haughey Rice & Roegge  
Spring Lake Community Fitness  
and Aquatic Center

Barbara J. Tevebaugh  
Jim Van Rees  
Wasserman's Flowers and Gifts  
Coral J. Wenell  
West Michigan Lakeshore  
Association of Realtors  
White Lake United Methodist  
Church  
Arlene & Warren Wickland  
Michael & Carol Wood

### Friends

Recognition of those who gave  
annual gifts of \$50 to \$499  
(From October 2019 to  
December 2021)

Colby Abernathy  
Edward J. Achterhoff  
Roseanna B. Achterhoff  
Mary Jane & Joshua Achterhoff-  
Lint  
Robin Ackley-Chase  
Kimberly L. Addicott  
Kathryn & Hans Agard  
Bonnie Allard  
Bradley Allard  
Charles Allard  
The Arc Muskegon  
Jamie T. Ardis  
Ann & John Augustin  
Richard K. Baker  
Karli L. Baldus  
Vernon & Pauline Barker  
Tarsha A. Barnett  
Jack & Rhonda Barrett  
Nicole Barton  
Bayle Family  
Brandon Bean  
The Bedroom Center  
Nicholas S. Beechnau  
Mandy M. Beets  
Karen Berens  
Colon C. Billinghurst  
Thomas & Karen Blais  
Glada Blanchette  
Jill & Brian Boersema  
Brenda Bouwman State Farm  
Richard & Natalie Boyd  
Chris & Birgetta Romaniello  
Brad Couch Builders  
Michael & Lindsey Breimayer  
Amy L. Brewer  
Richard & Shirley Brooks  
Louise Brouns  
Pete & Sherry Brown  
William & Connie Bruce  
Buboltz Family  
Jeffrey & Belinda Buck  
Larry F. Bull  
Zandra Burrell  
Joseph & Angie Bush  
Mary & Jack Butterick  
Carol Butzer

Barbara J. Carlson  
Nancy Carlson  
Daneen & Victor Caro  
Amy Cerullo  
Dennis & Marilyn Chandonnet  
Peter & Debra Charron  
Robin A. Chase  
Cheema, LLC  
Gary E. Cline  
Kristen M. Collee  
Frederick & Gail Colvin  
Honoring Byron Comin  
Community United Methodist  
Church  
Louise M. Cook  
Richard & Doris Cornell  
Kari A. Cottrell  
Amy M. Cribbins  
Marc Cripe & Kari Bean-Cripe  
Peggy L. Crow  
Custom Service Printers, Inc.  
Dan Cwynar  
Paul Damon  
Nicole D'Arcy  
Krista M. DeLong  
Richard & Louise DeMuro  
Leo & Gerri Denslow  
Britney Dice  
Dickey's Barbeque Pit  
Fredrick & Glenna Diehman  
James F. Diffell  
Teresa Dittmer  
Nancy J. Dobb  
Jamie & Michael Dodge  
Kevin & Suzanne Donovan  
Richard F. Dugan  
Amy L. Dupont  
Richard G. Eggleston  
Anthony Ellis  
Julie & Bill Erickson  
Corrinne Erickson-Strand  
Donna J. Esch  
Family Financial Credit Union  
Roy & Theresa Farrell  
Vladimer Ferrer  
Roger Rapoport & Martha Ferriby  
Randy S. Fisher  
Bonnie S. Fisher  
Erik J. Flores  
James & Laura Fox  
Jami L. Fox  
Thomas B. Fox  
Mary L. Frein  
Charles & Mary Fritz  
Douglas & Gail Frye  
James & Amy Gawron  
Sean & Dawn Gehle  
Staci M. Geiger  
James & Susan Geisler  
Martha Giacobassi  
Donald & Darcie Gilbert  
Richard & Trish Gilbert  
Dr. J.B. & Katherine Gilleland  
Mrs. Dale Glotzbach  
Jeff & Melissa Good

Stanley Gorecki & J. Groecki  
Grand Rapids Gravel Company  
Marti Grandinetti  
Dominic & Julie Greene  
Sherry L. Griswold  
Charles M. Hackley, III  
Barbara Hankins  
Ellen Hanley  
Sharon L. Hans  
Scott & Julie Hanson  
Susan Harper  
Tom & Fran Harryman  
Henry W. Hartwell  
Lois Havermans  
Jack & Sharon Hayes  
Kathy Hayes  
Danny W. Hearn  
Matt Hendrie  
Dave Henry  
Anthony & Heather Herrera  
Paul & Susan Hershey  
Ruby C. Hildreth  
Lorie Hilt & Family  
Carol Hodges  
Roger Hoekkenga  
Lavon Holmes  
Jennifer Homan  
Lori A. Horan  
Reginald & Sharon Horvath  
Kelly Hradsky  
Rodney & Roxanne Hudson  
Eileen Hughes  
Debra Hutchins  
John & Mary Jamieson  
Anna M. Jancek  
Tina & William Jancek  
Jeffery & Dianna Jelinek  
Mrs. Cynthia Johnson  
Erick & Holly Johnson  
Jamie L. Johnson  
Joanne E. Johnson  
Patricia S. Jones  
Joppie Family  
Don & Angie Kalisz  
Denise M. Kanaar  
Katherine Kasprzyk-Hayes  
Jim & Paula Kendra  
Randy W. Kenney  
Donald Kirksey  
Thomas E. Kitchen  
Dr. Jeffrey Kommit  
Randi & Richard Korc  
Brent Kowalski  
Kelly Kramer  
Clyde & Penny Krepps  
Ben & Louise Krill  
Janet K. Krivitzky  
Pamela Kroll  
Reg & Jody Kurtz  
Janet & Joseph Labiak  
Ladies of the Lake Quilting Group  
Ladies Philoptochos Society  
Lake Effect Construction  
Darryl V. Lane  
Mari & James Lane

Violet V. Lanning  
Cynthia & William Larson  
Erik C. Larson  
Robert & Pamela Lascko  
Phyllis Laurin  
Linwood & Sha-Ron Lee  
Trinecia L. Lefear  
William Leonard  
Frederic & Jeanne Livingston  
Mary L. Lombard  
Allan & Barbara Lowe  
Elizabeth Lubbers  
Gerald Lundeen  
Russell & Susan Mackie  
Constance Malburg  
George & Peggy Maniates  
Mary Marcil  
Florence Marvin  
Cheryl E. Masar  
Jamie & Gerilyn May  
Elizabeth A. Mayette  
Marian McDermed  
Garry & Julie McKeen  
Mike & Lynn McMaster  
Jenny McNeill  
Jane E. McPherson  
Kevin & Mikalea McWilliams  
Dale & Connie Mead  
Carole Meade  
Meijer (N. Muskegon)  
Christopher & Melinda Mendels  
Lisa & Thomas Metzdorf  
Bruce L. Meyer  
Janet A. Meyers  
Michigan Department of  
Corrections  
Amanda Mierendorf  
Lisa A. Miller  
Roger & Jane Missimer  
Kathryn J. Mock  
Kevin Mogdics  
Kimberly Montgomery  
Moon Elementary School  
Carol & Matthew Moore  
Prudence & Bruce Moore  
Morat's Bakery  
John S. Morgan  
Gene & Sally Mund  
Debbie Murak & Friends  
Janna & Rob Murray  
Marsha Musil  
Muskegon Chapter of the  
Daughters of Penelope  
Muskegon Surgery Center  
Kelly Napierala & friends  
Nelson Neighborhood  
Improvement Association  
Sandra O. Neville  
Jack & Jodie Newhouse  
Nipote's Italian Kitchen  
Martha Noble  
Martin J. Nolan  
Ronald Norton  
Mary Beth Nowak  
Steven & Mary Jo Nowak



Oakridge Upper Elementary School  
Dr. Charles M. O'Brien  
Omt-Veyhl Global Supply Chain  
Chip J. Oosdyke  
David & Marsha Outwin  
Matthew T. Palmer  
Ella Parker  
Mehul Patel  
Richard Paul  
Peckadill's  
Janet R. Perrault  
Andrea & Robert Perri  
Dr. Erin Pettijohn  
Edward & Judith Pietila  
Varun Piplani  
Pizza Hut (Henry St.)  
Douglas G. Platt  
Kelly & James Plichta  
Jean Plummer  
Ellen D. Porter  
Deborah A. Potter  
Patricia A. Preston  
Lisa A. Price  
Richard Pugliese  
Mary Beth Ramos  
David Reed  
Dr. Sarah Reed  
Revel  
Bruce & Mari Rice  
Krisena L. Rieger  
Chad Roach  
Jane E. Robidoux  
Roger L. Routt  
Thomas G. Ruthkoski  
Michael & Stacey Sanderl  
Garry Sandy  
Duane & Susan Schechter  
Pamela A. Schelhas  
Jean L. Schilleman  
Michael & Brenda Schluentz  
Susan & Robert Schuiteman  
Janice E. Schumacher  
Donald & Mary Scofield  
Jessica Semelbauer  
Service1 Federal Credit Union  
Stephanie & Joe Shaffer  
Bob & Cindy Shaver  
Shelby State Bank  
Mary & Jack Siebers  
Amy & Josh Silvis  
Mary Jeanne & Gary Silvis  
Gary Siscoe  
Robert J. Smit  
Darlene Smith  
Frank & Barbara Smith  
Sharon K. Smith  
Mindy Snyder  
Tracy & David Sodini

Justin S. Spence  
Alexander Starbuck  
Marjorie M. Stauffer  
Michael & Kerry Stewart  
Eileen B. Stoffan  
Theodore & Judith Stojak  
Denise & Dirk Stone  
Julie Straley  
Stephen & Ruthann Stream  
Lynn F. Stribley  
Eliza R. Sudbury  
Joshua Suderman  
Wendy & David Swenson  
Heidi & Marty Sytsema  
Bryce & Marti Tallant  
Teddy Spaghetitis  
Texas Roadhouse  
Cindy S. Thielman  
Third Coast Cycling, LLC  
Mary Towner  
Aaron Turner  
Mary Tyler  
UAW Local 1243  
Michael & Patricia Urbanawiz  
David & Laura Valk  
Erin VanderWerp  
Mary VanderWest  
Scott & Lindsay VanDonkelaar  
Nina J. VanDop  
Christy A. Vanhoven  
Terrance Veach  
Russell & Dolores Veihl  
David & Lori Versalle  
Waters Edge Fitness, LLC  
Tony D. Weinrick  
Daniel & Nancy Weller  
West Michigan Family Dentistry  
Sally & Mark White  
Katharine H. Wierengo  
Wonderland Distilling Co.  
Scott & Lynn Woodard  
Cathy & Jon Workman  
David & Mary Workman  
David & Jane Wright  
Dwane Wright  
Judy Yonker  
Robert & Marti Yonkers  
Bernadette Young  
Kimberly Young  
Louis M. Zaloga  
Chester & Marjorie Zbojniewicz  
Cindy Zeck & Kristy Maki  
Gregory & Christy Zerlaut  
Jing Zhou  
Douglas & Lisa Zuidema

## With Gratitude to our Mercy Health Family of Supporters

Mercy Health is honored to present the names of our medical staff members, colleagues and volunteers who have given charitably, helping to continue the advancement of health care in our communities.

### Sociati Sanare

*{Latin} Society of Healers*  
**Recognizing our distinguished healers — physicians and advanced practice providers — who currently give to Mercy Health Muskegon. We are thankful for their skills and gifts, which are building the health and well-being of our communities.**

Jeffrey V. Amstutz, RPh  
Andrew C. Arter  
Harry R. Arthur, DO  
Dr. Michael Banka  
Dr. Anthony D. Barclay  
Ann M. Bays, NP  
Timothy Beechnau, DO  
Dr. Joseph A. Betcher  
Mr. Taylor W. Blanchette  
Dr. Matthew A. Bowen  
Dr. Monica A. Bowen  
Dr. Mary D. Boyer  
Dr. Mathew J. Brakora  
Dr. Caitlin Brazda  
Dr. Nancy F. Brenneman  
Dr. Wayne L. Brenneman  
Dr. Gerald L. Buchanan  
Sharon Christian, MD  
Dr. Timothy J. Cook  
Dr. Patrick M. Couture  
Dr. Donald K. Crandall  
Dr. Maryvic C. Cuison  
Dr. William Deaton  
Dr. David H. Deitrick  
Dr. Kelly Ann deLongpre  
Dr. Gregory Downer  
Tammy J. Draggo, RPh  
Dr. Bryan Eadie  
Wade C. Engers, PA-C  
Dr. Jerry A. Evans  
Dr. Christine R. Faser  
Dr. David R. Folkmier  
Dr. Mark J. Foreman  
John T. Foss, PA-C  
Dr. Alison Fox  
Dr. Steven R. Fox  
Lauren Gaines, PA-C  
Dr. Suzanne Galloway  
Dr. Courtney A. Garlick  
Timothy M. Gawronski, PA  
Thea Gawronski, PA  
Dr. Brian Gluck  
Dr. Gretchen C. Goltz

Dr. Jennifer Goodrich  
Dr. James R. Grace  
Joseph A. Graftema, PharmD  
Dr. Justin E. Grill  
Dr. Yousif I. Hamati  
Dr. Scott C. Harris  
Dr. Thomas E. Hill  
Dr. B. Rolf Hissom, Jr.  
Dr. Douglas E. Hoch  
Dr. Robert A. Hoogstra  
Dr. Steven Huder  
Dr. Seth Jaskowiak  
Kelly M. Jensen, PA-C  
Harrison W. Johnson, MD  
Nina F. Johnson, MD  
Dr. Peter Kamhout  
Kathryn E. Kampen, MD  
Dr. Dick L. Kamps  
Michelle C. Klanke, DO  
Holly L. Knowles, PA-C  
Dr. Jeffrey Kommit  
Dr. Raymond R. Komray  
Michael E. Krohn, DO  
Dr. Heather LaClair  
Dr. John E. LaGorio  
Lajide R. Lawoyin, MD  
Grace K. LeBlanc, PA-C  
Dr. Lucas Leete  
Dr. Kok Hoo Lim  
Dr. Lawrence Mallon  
Dr. Joseph J. Marous  
Dr. Christopher L. Marquart  
Dr. Michelle M. Matheson  
Jean G. McCarty  
Dr. Janice L. McDonald  
Sean T. McGavin, DO  
Dr. Nicholas M. McManus  
Dr. Carl Metcalf  
Dr. David D. Milek  
Matthew T. Moser, PA-C  
Jennifer Mosher, NP  
Dr. Joan E. Nagelkirk  
Dr. Ryan Offman  
Julie Olechnowicz, NP  
Ena K. Osterhouse, PA-C  
Dr. Srdjan Andrei Ostric  
Dr. Elizabeth F. Pallante  
Dr. Mark R. Pennington  
Dr. Bryan Pereira  
Dr. Richard W. Peters  
Dr. Elizabeth S. Pitt  
Lisa A. Potts, PharmD  
Dr. Aaron Potts  
Dr. J. Michael Ratchford

Dr. MaryEllen E. Rosel  
Dr. Tyler Rummel  
Dr. Bart D. Sak  
Dr. Joseph Salisz  
Dr. Edward Sara, III  
Dr. Elaine M. Schmidt-Koopman  
Dr. Rachel A. Shields  
Dr. Brian Smith  
Dr. Angela N. Sneider  
Dr. F. Remington Sprague  
Dr. John Stephenson  
Dr. Kevin Stone  
Dr. John C. Strainer  
Dr. Heidi E. Suidinski  
Dr. Matthew D. Sunderlin  
Dr. Tina L. Tanner  
Dr. Matthew L. Tate  
Preston Taylor, PharmD  
Dr. Christopher L. Towns  
Dr. Chad K. Uptigrove  
Dr. Daniel Vickers  
Dr. Thomas L. Watkins  
Daniel L. West, MD  
Dr. Marc E. Whitaker  
Dr. Richard A. Wilcox  
Dr. Kristen K. Woods  
Mansour Yacoub, MD  
Dr. Marc B. Ydenberg  
Dr. Katherine L. Young  
Tara Zdybel, PharmD  
Dr. Stephen N. Zonca

### Team Club

**Recognizing colleagues and volunteers who currently give to Mercy Health Muskegon and the McAuley Fund. We are grateful for their generosity, compassion and commitment to health care excellence.**

Anita Absher  
Megan Akselberg  
Gary Allore  
Debra Alman  
Paula Andersen  
Amy Anderson  
Jessica Anderson  
Denise Andrews  
Kristi Arends  
Lindsey Armstrong  
Darshikia Aubrey  
Cynthia Bagley

*If we have made an error or omission on these supporter lists, please let us know and accept our sincere apology.*

Theresa Balavitch  
Kelly Baldwin  
Savannah Ballard  
Theresa Baxter  
Samantha Bays  
Amanda Beishuizen  
Robin Belcourt  
Anita Benninger  
Doris Betka  
Heather Beyer  
Michelle Bierman  
Judy Binns  
Mhairi Blacklock  
Jessica Blackmer  
Misty Boerman-Wright  
Debra Boes  
Samantha Boggs  
Keelin Bonga  
Kathleen Bonthuis  
Connie Boone  
Gerald Booth  
Devon Bordeaux  
Tricia Boroff  
Linda Bourdon  
Tonia Bourdon  
Tadji Bowen  
Mary Ann Boyer  
Kimberly Bramer  
Shannon Brannam  
Renee Braun  
Michael Brecht  
Melissa Bredernitz  
Ashley Breeman  
Thomas Briggs  
Sherri Briggs  
Jackie Britzen  
Shelley Brocci  
Jamie Brooks  
Ann Marie Brown  
Hayley Bryant  
Jennifer Buchmiller  
Shane Buchmiller  
Isabel Bullock  
Linda Burpee  
Rhonda Butterfield  
Thomas Cabot  
Randi-Nicole Cain  
Maureen Cannon  
Mary Carlson  
Tricia Carmean  
Holly Carpenter  
Cassidy Carr  
Misty Carr  
Kimberly Carter  
Lana Cassidy  
Armelinda Caviedes  
Robert Cecot  
Liz Chala-Hidalgo  
Jennifer Chandler  
Rita Chandonnet  
Jillian Chase  
Sheryl Chase  
Caitlin Clay  
Karla Cleveland  
Martha Cloz

Candace Cloud  
Amy Colby  
Nikkole Cole  
Candace Coleman  
Joyce Coleman  
Deaundra Cook  
Kim Cooke  
Yvonne Corbett  
Alicia Cox  
Camilla Croschere  
Jeannie Cross  
Beth Curley  
Bobbiejo Dahl  
Janet Dake  
Christopher Davey  
Tina Davidson  
Mariposa Davis  
Laura DeBruin  
Mark Deckinga  
Samantha Deering  
Mark Densford  
Amanda Derose  
Brian Dethloff  
Wesley Dews  
Daria Donovan  
Charlene Drake  
Ramon Droughn, Sr.  
Laurie Drzewicki  
Barbara Duell  
Linda Dunmore  
April Dunne  
Ryann Dykstra  
Julissa Eikenberry  
Deborah Eisen  
Traci Eldridge  
Jessica Ely  
Julie Anne Ely  
Tiffany England  
Katherine Espinoza-Diaz  
Susan Everett  
Sandra Eyestone  
Sarina Farrell  
Susan Farrell  
Colleen Fitch  
Laura Fitzpatrick  
Jennifer Fleming  
Rebecca Forbear  
Jeanie Forton  
Miles Fouty  
Dawn Francis  
Tara Frees  
Dirk Fuller  
Monica Gallegos  
Nathalie Gardner  
Joy Gawron  
Brianna Gerlach  
Amanda Gilbert  
Jasmine Gillette  
Stephanie Giltrop  
Lajeanna Gloeckner  
Heather Godleski  
Holli Gomez  
Cary Gonzales-Navarre  
Cheryl Goodell  
Ruby Goodman

Shauna Gorajec  
Cindy Gordon  
Ashley Gowell  
Sarah Grabe  
Michelle Gravlin  
Sandy Grecheski  
Elizabeth Green  
Heidi Greene  
Jasmine Grider  
Brandyn Grieve  
Michael Gusho  
Leaann Haase  
Melissa Haight  
Christopher Halberda  
Christina Hall  
Brett Hallberg  
Lorelle Hallenbeck  
Kiara Hamilton  
Wendy Hamilton  
Brooke Hanson  
Vivian Harker  
Lisa Harman  
Megan Harper  
Kristie Harvey  
Heather Hawley  
Sharon Hayes  
Rod Hayhurst  
Victoria Hedemark  
Kristina Hedges  
Melanie Hekkema  
Michaelanne Hendrixon  
Dawn Henrick  
Christina Hernandez-Flores  
Alaina Herrmann  
Michelle Hester  
Cindy Hoagland  
Lisa Hoagland  
Cassidy Hobby  
Anne Hoekenga  
Jeannine Hoerle  
Crystal Hofman  
Dionna Holden  
Tracy Host  
Michelle Howarth  
Laura Hughes-Blough  
Cindy Hulka  
Amy Hunter  
Amy Huss  
Kaslana Hussey  
Richard Hyatt  
Michele Inman  
Kaitlyn Jackowski  
Shannon Jados  
Haylie Jensen  
Jamie Jimenez  
Andra Johnson  
Kaitlyn Johnson  
Kelli Johnson  
Marie Johnson  
Tracy Johnson  
Yvonne Johnson  
Krystal Johnston  
Rachel Jonaitis  
Kalon Jones  
Zachary Juergens

Cheryl Kaley  
Maryann Kampenga  
Ashley Kareste  
Tricia Karnes  
Kathy Kartes  
Navdeep Kaur  
Mary Kay  
Juliana Keeney  
Mark Keiser  
Judith Kell  
Carrie Kelly  
Alycia Kemme  
Steven Kemme  
Joan Kessler  
Brenda Ketchum  
Lindsey Ketner  
Linda Keur  
Angelina Kies  
Jennifer Kilbry  
Shelby Klingler  
Melanie Klomp  
Ronda Klootwyk  
Laura Kolkman  
Christi Kosheba  
Joshua Kotecki  
Renee Krapp  
Michelle Kucera  
Kelly Kurburski  
Michael Kurtzweil  
Mallorie Lacosse  
Kimberly Ladewig  
Janet Lambert  
Wilma Langeland  
Kimberly Lapins  
Shawn Lazarock  
Terri Lemense-Acton  
Joseph Levandoski  
Angela Leyrer  
Laura Liebertz  
Lynne Lillibridge  
Deborah Lincoln  
Rhonda Livers  
Tonja Longmire  
Alicia Lopez  
Anne Lucas  
Kelly Luczak  
Diego Luna  
Kurt MacDonald  
Susan Macdonald  
Cassy Macfadyen  
Kelly Madole  
Esther Manley  
Connie Mann  
Nicole Manthei  
Julie Markowski  
Christopher Mason  
Nicole Mason  
Vicki Mayo  
Lakisha McBride  
Andra McConnell  
Marilyn McKeown  
Maryam McLouth  
Jabrea McQuarter  
Kasandra McVeigh  
Ashley Melchert

Jenny Merrill  
Lars Mertens  
Edo Mestrom  
Kristine Mestrom  
Ashley Miller  
Bethany Miller  
Desiree Miller  
Kaylee Miller  
Mandy Miller  
Mary Miller  
Ashley Millstead  
Nathan Minnema  
Marcella Minzey  
Cory Mitchell  
Susan Mitchell  
Lisa Moon  
Vicki Moran  
Blair Moreau  
Courtney Morgan  
Lon Morrisson  
Christine Mosqueda  
Meggan Muchna  
Rebecca Mueller  
Kristi Nagengast  
Ricky Navarre  
Heidi Neiser  
Holly Nelson  
Tammy Nelund  
Jessica Neuman  
Beverly Newcomer  
Megan Nguyen  
Catherine Nicholoff  
Kendra Nyhof  
David Ogren  
Karl Okerlund  
Rebecca Oldaker  
Brandy Olivas  
Michelle Olmstead  
Barbara Olsen  
Jessica Olson  
Damian Omness  
Veronica Osborne  
Amy Overley  
Nathan Page  
Rachael Palmer  
Marideth Palsrok  
Nanette Panici-Farrell  
Christopher Parisian  
Erin Patrick  
John Pawlowski  
Christa Payne  
Emily Peake  
Holly Pease  
Vickie Pendergast  
Ann Pendery  
Eva Pereda  
Christopher Perry  
Debra Perry-Philo  
Christine Perysian  
Greg Petersen  
Emma Peterson  
Julie Phipps  
Sandra Picard  
Akia Pierce  
Michelle Pikaart

Amanda Pletcher  
 Amy Poe  
 Kristina Pollack  
 Angela Porter  
 Doris Prell  
 Jodi Prescott  
 Craig Price  
 Ronald Price  
 Paula Prince  
 Beth Provencal  
 Candy Prow  
 Toni Pruitt  
 Laura Puls  
 Paula Quick  
 Renee Rademacher  
 Shaun Raleigh  
 Caroline Rasey  
 Renee Raspotnik  
 Kelli Rebone  
 Kelly Rebone  
 Lindy Reed  
 Makayla Rennells  
 Katie Rhew  
 Amy Richards  
 Mary Richardson  
 Stevi Riel  
 Aryelle Riffle  
 Bambi Rinehart  
 Debra Ripka  
 Lori Rivera  
 Chevonne Robbins  
 Lisa Robertson  
 Lisa Rockwell  
 Christina Rodgers  
 Safiya Rogers

Sherri Rogers  
 Tina Rogers  
 Estella Rohm  
 Antonio Romanelli  
 Jon Romkema  
 Laura Rose  
 Lisa Rose  
 Naomi Rose  
 Hillery Ross  
 Emily Rosso  
 Kaitlyn Rudicil  
 Daniel Russell  
 Laura Sample  
 Christina Sanchez  
 Nicole Sanchez-Melchor  
 Stephanie Sandilands  
 Kelly Scaffido  
 Ashley Scheidel  
 Anna Scheuerle  
 Mark Schmiedeknecht  
 Thomas Schmiedeknecht  
 Paula Schmuck  
 Brooklyn Schneider  
 Courtney Schnettler  
 Sherri Schroer  
 Carrie Scott  
 Shauntina Seals  
 Debbie Sells  
 Patience Seward  
 Jill Shaw  
 Marlene Shields  
 Heather Shrum  
 Bonnie Shuker  
 Jeni Silberman  
 Cathleen Sines

Holly Sircher  
 Elaine Skinner  
 Grant Smith  
 Kitty Smith  
 Taylor Smith  
 Jennifer Smyth  
 Melissa Snyder  
 Jenna Soper  
 Kenneth Span  
 Dena Squiers  
 Jennifer Stalzer  
 Jessica Stanley  
 Deanna Stembol  
 Christopher Stemler  
 Alyssa Stephenson  
 Melissa Sterken  
 Daniel Stewart  
 Deni Stidham  
 Rebekah Stitt  
 Maureen Stock  
 Christopher Strait  
 Taylor Strandberg  
 Hattie Suarez  
 Patricia Suarez  
 Joslin Sullivan  
 Leslie Swanker  
 Linda Swanson  
 Sandra Swanson  
 Kristyn Switzer  
 Kaleigh Swords  
 Stacey Tarte  
 Lee Ann Tencate  
 Edward Tennison  
 Barbara Terrien  
 Samantha Tetzloff

Sara Thiele  
 Stephanie Thomas  
 Margaret Thompson  
 Spencer Thomson  
 Mark Tierman  
 Russell Tilden, Sr.  
 Adam Tomlinson  
 Rebecca Toney  
 Marla Touzel  
 Iris Towers  
 Susan Tregoning  
 Lydia Trevino  
 Amanda Trombley  
 Dianna Trudeau  
 Edith Turner  
 Robin Twining  
 Ashley Van Artsen  
 Carol VanAndel-Forbes  
 Gary Vanderheiden  
 Susan Vandervan  
 Carissa Vanduinan  
 Terri Vandyke  
 Tanya Vanotteren  
 Susie VanRaalte  
 Clarence Veen, III  
 Anne Vekved  
 Kurt Veltman  
 Jill Venné  
 Lisbet Vera  
 Cindy Visscher  
 Maryanne Von Ins  
 Robert Voyt  
 Theresa Vree  
 Sarah Wadsworth  
 Courtney Wakefield

J'lisa Walker  
 Temeka Ware  
 Sara Watrin  
 Myra Watson  
 Chalie Weaver  
 Claudine Weber  
 Latecha Wedlaw  
 Michael Weessies  
 Heather Wendt  
 Sandra Wernstrom  
 Bethany Westbrook  
 Cheryl Westbrook  
 Melissa Westmaas  
 Angela Whipple  
 Jakesha White  
 Karly Wiggins  
 Julie Wilde  
 Kari Wildeboer  
 Dominique Williams  
 Michelle Williams  
 Shantrese Williams  
 Dave Witham  
 Carrie Wolf  
 Harvey Wolters  
 Kristen Worcester  
 Heather Worth  
 Amy Wright  
 Breanna Yeary  
 Katisha Young  
 Donna Zambetis  
 Connie Zornes

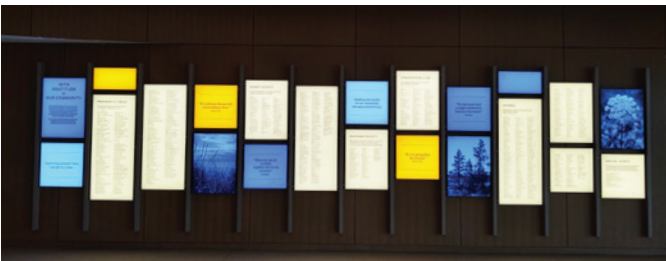

Mercy Health Muskegon is honored to recognize our supporters on the displays located in the main lobby and Garden Level. These beautiful donor walls were recently updated.

If you are not already listed, we invite you to consider joining our family of supporters. We welcome and appreciate gifts of all sizes and annually recognize gifts of \$50 and up.

*To learn more about our flexible giving options, contact Emma Peterson at 231-672-4814 or [emma.torresen@mercyhealth.com](mailto:emma.torresen@mercyhealth.com).*

## Special Events

Recognizing community groups, businesses and organizations that host fund-raising events to support Mercy Health Muskegon.

- Ray & Lila Allard Memorial Cancer Scramble
- American Cribbage Congress
- Cars for Cancer Labor Day Car Show & Cruise
- Tommy Davis Memorial Golf Outing
- Lake Michigan Credit Union Band Together Program
- Muskegon Firefighters — IAFF Local 370 No Shave November
- PetSmart Chance & Friends Donation Program
- Pledge the Pink
- Ryke's Cookie Poll
- Salomon's Karate Studio Kick-a-thon
- Thunderbird Raceway's Rolling Thunder
- Tim Hortons Smile Cookie and United Donut Programs

# Inspiring Corporate and Community Support

## Pledge the Pink

Norton Shores, Michigan, resident Linda Porter joined forces with a national breast cancer foundation and raised funds through can collections, sales, and partnerships with local businesses. By exceeding her goal, she got to choose a local charity to receive a portion of the funds. Linda raised \$8,456 that will support screening mammograms and assist our Comprehensive Breast Center patients.



## Salomon's Karate Studio Kick-a-thon 2021

Since 2015, Salomon's Karate Studio's Kick-a-thon has raised support for multiple disciplines at Mercy Health Muskegon. The November 2021 event hosted 14 kickers of all ages who secured sponsors for the maximum number of kicks they could manage in a three-hour period. A total of 35,308 kicks were counted by the judges! Funds from the 2021 event supported the Mercy Health Comprehensive Breast Center, a department with special meaning for studio owner Salomon Villalpando and his family.



## Ray & Lila Allard Memorial Golf Scramble

In 2021, Chuck Allard of Spring Lake, Michigan, celebrated the 25<sup>th</sup> anniversary of the Allard Memorial Golf Scramble. Chuck and family organize the event in memory of his parents, Ray and Lila Allard. Held annually at the Oak Ridge Golf Club, the scramble originally began as an idea of Chuck's mother, Lila, to honor her husband's memory by raising funds for the Johnson Family Cancer Center (JFCC). In total, the Allard Memorial Golf Scramble has raised over \$85,000 for the JFCC.



## PetSmart

PetSmart customers brought smiles and comfort to kids who visit Mercy Health. Through the Annual Chance & Friends Toy Donation program, the Muskegon store donated 3,500 plush toys. To distribute the toys, Mercy Health colleagues, along with members from area agencies, including Muskegon Police Department, ProMed and SafeKids West Michigan, filled police squad cars, ambulances and several other vehicles to the brim! More than 30 Mercy Health locations received toys for kids.



### **Fremont Insurance**

On Christmas Eve, for the past two years, Fremont Insurance has sponsored hot coffee from Brooklyn Bagels for our colleagues on the frontlines. Beth Frey, Marketing Sales Support Specialist II, made the early morning deliveries to the hospital to show our colleagues how much they care. Pictured are Beth's children, Addison and Austin, who helped make the delivery.



### **Best Financial Credit Union**

For Christmas 2021, Best Financial Credit Union of Muskegon, treated Mercy Health Colleagues to 1,000 bags of caramel corn! Colleagues throughout the hospital were thrilled to receive them. Thanks to Best Financial Credit Union for thinking of our colleagues with this delicious treat during the holiday season.



### **Ladies of the Lake Quilting Group, Quest Book Club and Pints & Quarts**

Nancy Peters, a member of the Ladies of the Lake Quilting Group and Quest Book Club, led the charge to raise donations to gift meals to Mercy Health Muskegon colleagues. Nancy partnered with local restaurant Pints & Quarts, which generously matched the number of meals the groups funded. In total, they donated 68 meals. Our colleagues appreciate meals given by the community.



### **Annunciation Greek Orthodox Church Groups Daughters of Penelope, Antiope #109 and Philoptochas Ladies Society and Pints & Quarts**

We are thankful to groups from the Annunciation Greek Orthodox Church, Norton Shores, Michigan, who, together with Pints & Quarts, provided Mercy Health colleagues with 84 fresh and delicious meals.

**Great Harvest Bread of Grand Haven and Harvest Spring Lake** provided 125 loaves of delicious, freshly baked bread for our colleagues to take home and share with their families during the holidays.

*Special Thanks!*

To learn more about how your business or organization can support Mercy Health Muskegon, please contact Megan Akselberg at [megan.akselberg@mercyhealth.com](mailto:megan.akselberg@mercyhealth.com) or 231-672-6976.



# An Incredible Legacy

Hans F. Hansen, or Fred, as he was called, was born in Muskegon in 1882 to Christian and Sophia Hansen, who were immigrants from Denmark and honored pioneer citizens of Muskegon. Mr. Hansen was one of the founders of Madison Manufacturing Company in 1915, and at the time of his death in 1942, was the president of the company.

In his 1933 will, Mr. Hansen designated his entire estate "to aid such worthy or indigent persons as are, in the judgement of said hospital authorities, unable to pay the whole or in part the customary charges for hospital care and treatment."

*Thanks to Mr. Hansen's incredible gift, 80 years later his trust generates almost \$20,000 per year for our Mercy Health Gift of Health fund, lessening or eliminating the burden of hospital bills for many patients and their families each year.*

## Planning a Future Gift to Mercy Health Muskegon

Many people donate to organizations they care about during their lifetimes, but fewer take the step to continue that support after they're gone. Planning a future gift is easy, leaves a lasting impact on our community and a legacy for your family.

**The beneficiary designation form of your life insurance policy, retirement or investment account** is a simple and quick way to include Mercy Health Muskegon in your plans. Even a small percentage can result in a meaningful gift.

**Your will or trust can include a charitable beneficiary** for any amount of your estate — big or small. These documents should be revisited every handful of years or after a significant life event like marriage or retirement. And, if you haven't yet created a will, now is the time!



Emma Peterson,  
Director of Philanthropy

Learn more by contacting Emma Peterson, Director of Philanthropy at 231.672.4814 or [emma.torresen@mercyhealth.com](mailto:emma.torresen@mercyhealth.com).

Mercy Health Muskegon is a qualified 501(c)3 non-for-profit organization. Tax ID: 38-2589966.

# Know the Signs of a Heart Attack

## Heart Attack Signs in Men

Heart disease is the #1 cause of death for men in the U.S.

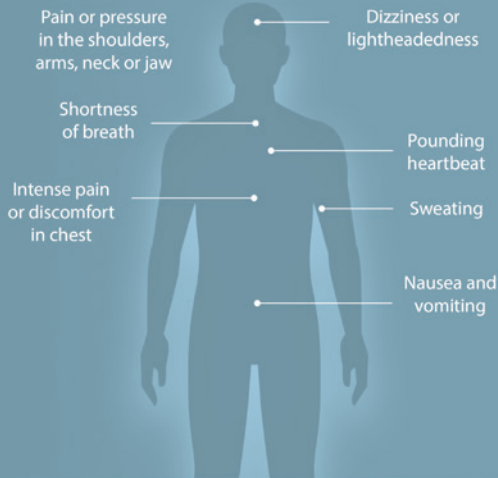

## Heart Attack Signs in Women

Women may have these symptoms **with or without** chest pain.

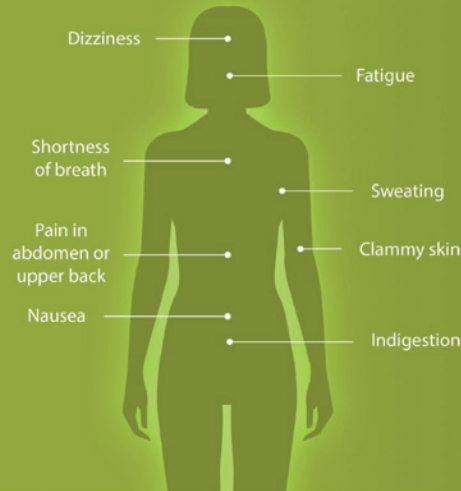

Did you know that properly managing your weight, blood pressure and cholesterol levels can prevent or delay heart disease and its complications? We encourage you to care for yourself and your loved ones through regular health screenings.

*Schedule your appointment with a Mercy Health physician today at [MercyHealthPhysicianPartners.com](http://MercyHealthPhysicianPartners.com).*

## Local Board, Philanthropy Council and Staff

Mercy Health Muskegon is fortunate to have the support of these dedicated leaders, providers and colleagues whose diverse experiences and connections to the communities we serve are foundational to our mission of healing. The local board leads our health system. The Philanthropy Council and Office of Philanthropy are dedicated to securing philanthropic funding in support of our patients and our mission.

### Local Board Members

Mishelle M. Comstock, Chair  
Richard Wilcox, MD, Vice Chair  
Camille Jourden-Mark, Secretary  
Gary Allore  
Jerry Evans, MD  
Martha Ferriby  
Erick Johnson  
Gregory LaPres  
Aaron Maike, Ph.D.  
David E. Ramos  
James J. Steffel  
Douglas Zwemer, MD

### Philanthropy Council

#### Executive Committee

Mark Fazakerley, Chair  
Gary Allore  
Shelley Brocci  
Karen Kayes  
Kay Olthoff  
Claudine Weber

#### Planned Gifts Committee

Karen Kayes, Chair  
Jackie Engel  
Brenda Jacobs  
Emma Peterson  
Steve Woodcock

#### Signature Gifts Committee

Kay Olthoff, Chair  
Gary Allore  
Tim Arter  
Shelley Brocci  
Mark Fazakerley  
Greg Gust  
Trip Johnson  
Scott Musselman  
Mary Price  
Roger Spoelman  
Ginny Sprague

### Office of Philanthropy Staff

Claudine Weber  
*Chief Philanthropy Officer*  
Emma Peterson  
*Director of Philanthropy*  
Megan Akselberg  
*Stewardship & Donor Relations Officer*  
Joan K. Kessler  
*Philanthropy Communications Manager*  
Courtney Wakefield  
*Philanthropy Services & Prospect Development Manager*  
Ann Pendery  
*Executive Assistant*

Mercy Health Muskegon Office of Philanthropy is dedicated to enhancing the superior care provided by our health system through financial support from the community. This support sustains our mission to be a compassionate healing presence in the communities we serve.

Mercy Health Muskegon is a qualified 501(c)3, not-for-profit organization. All gifts stay local and honor our donors' intent. Gifts are tax deductible as allowed by state and federal law.

Tax ID: 38-2589966

**For more information,  
please contact us:**

Mercy Health Muskegon  
Office of Philanthropy  
1500 E. Sherman Blvd.  
Muskegon, MI 49444  
231-672-4890

If you do not wish to receive information from Mercy Health Muskegon Office of Philanthropy in the future, please call 231-672-4890 or email [mhphilanthropy@mercyhealth.com](mailto:mhphilanthropy@mercyhealth.com)

MercyHealthMuskegonGiving.com

**BeRemarkable.**

**OFFICE OF  
PHILANTHROPY**



**Mercy Health Office of Philanthropy**

1500 E. Sherman Blvd.  
Muskegon, MI 49444

Non-profit  
Organization  
U.S. Postage  
PAID  
Grand Rapids, MI  
Permit #657

**Mercy Health Muskegon has earned several awards for quality patient care.**



**Rated a Top Performing Hospital for Stroke Care**

Be 100% confident.  
BeRemarkable.



A Member of Trinity Health



**Top 10% in the Nation for Coronary Intervention**

Be strong-hearted.  
BeRemarkable.



A Member of Trinity Health

**CMS Five-Star Hospital for Quality and Experience**



Be delighted. BeRemarkable.



A Member of Trinity Health